

**TYPICAL SECTION
RAILROAD SIDING TANGENT TRACK**

SCALE = 1:30

FROM STA:109+05.03 TO STA:109+61.55
 FROM STA:113+21.72 TO STA:116+45.86
 FROM STA:130+66.07 TO STA:141+62.39

* SEE CROSS SECTIONS FOR DETAIL.

NOTES:

1. THE CONCRETE TIE AND TRACK RAILS ARE FOR INFORMATION ONLY. THESE ITEM ARE NOT PART OF THIS CONTRACT.
2. SUBGRADE AND SUBBALLAST SHALL BE PROVIDED BY THIS CONTRACT AND SHALL COMPLIED WITH AREMA SPECIFICATIONS.
3. PROVIDE A MINIMUM CLEARANCE OF 25mm. BETWEEN THE BOTTOM OF THE RUNNING RAIL AND THE TOP OF BALLAST IN ALL LOCATIONS.
4. A GEOTEXTILE FABRIC SHALL BE INSTALLED UNDER THE SUBBALLAST.
5. UTILITIES CABLES ARE NOT PART OF THIS CONTRACT
6. FOR BRIDGE DETAILS SEE DWNG. BR.

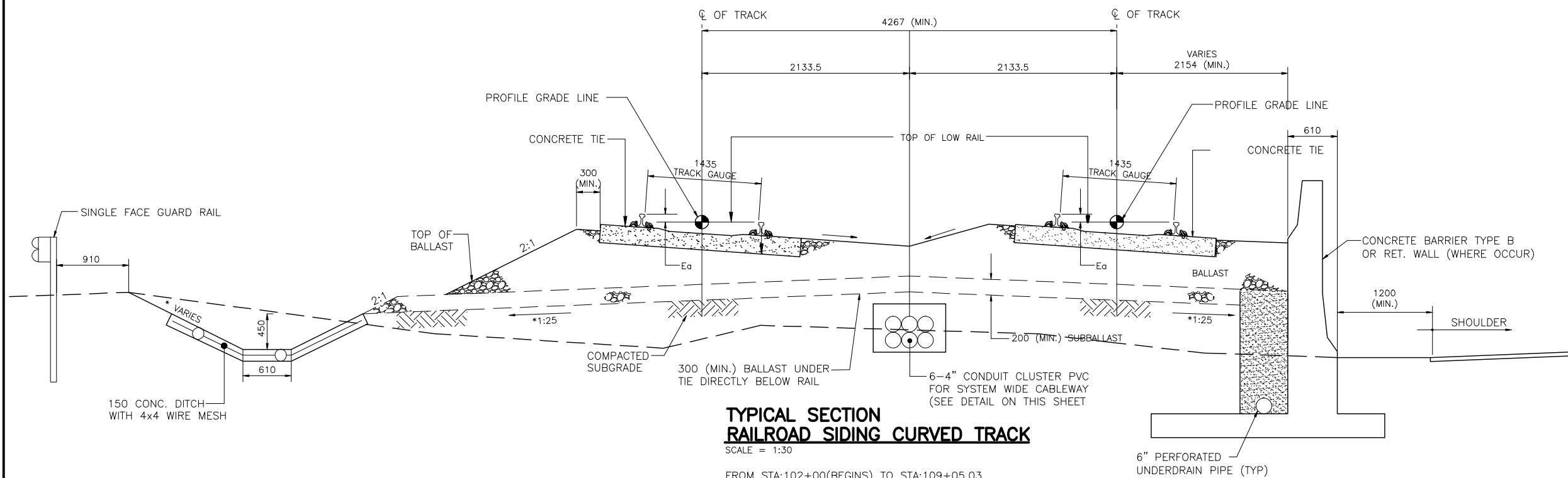

**TYPICAL SECTION
RAILROAD SIDING CURVED TRACK**

SCALE = 1:30

FROM STA:102+00(BEGINS) TO STA:109+05.03
 FROM STA:109+61.55 TO STA:113+21.72
 FROM STA:116+45.86 TO STA:130+66.07
 FROM STA:141+62.39 TO STA:156+00.00(END)

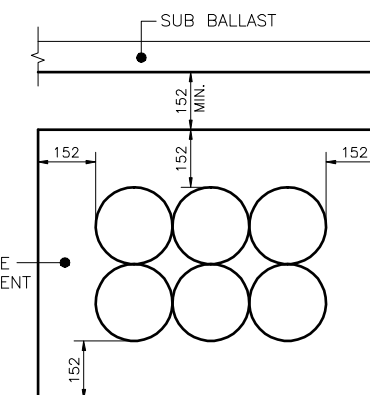

6-4" CONDUIT CLUSTER PVC FOR SYSTEM WIDE CABLEWAY

CONDUIT CLUSTER DETAIL

BYA FILE: H:\D6003_TREN_SJ-CAGUAS\00-Final\WORKING FILES\ambiental\GR-8.dwg
 PLOT DATE: April 29, 2008

REV.	DATE	DESCRIPTION

PREPARED BY: DR	
DRAWN BY: RMC	
CHECKED BY: EC	
DATE:	

Cond. Iberia 1 Suite 4-3, Calle Perseo 554, Altamira, San Juan, P.R. 00920 Tel.783-0290

SUBMITTED _____

PRELIMINARY PLANS

**TYPICAL TRACK SECTIONS
RAILROAD SIDING
TANGENT & CURVED TRACK**

CONTRACT NO. INTECO 000100	REV.
DRAWING NO. GR-8	
SCALE: 1:30	
SHEET NO. 9	